

WARING COMMERCIAL

UK Xtreme Blender with
4 Reprogrammable Beverage Stations
and a 48 oz. Stackable Raptor Container
with Sound Enclosure

MX1500XTPSEK

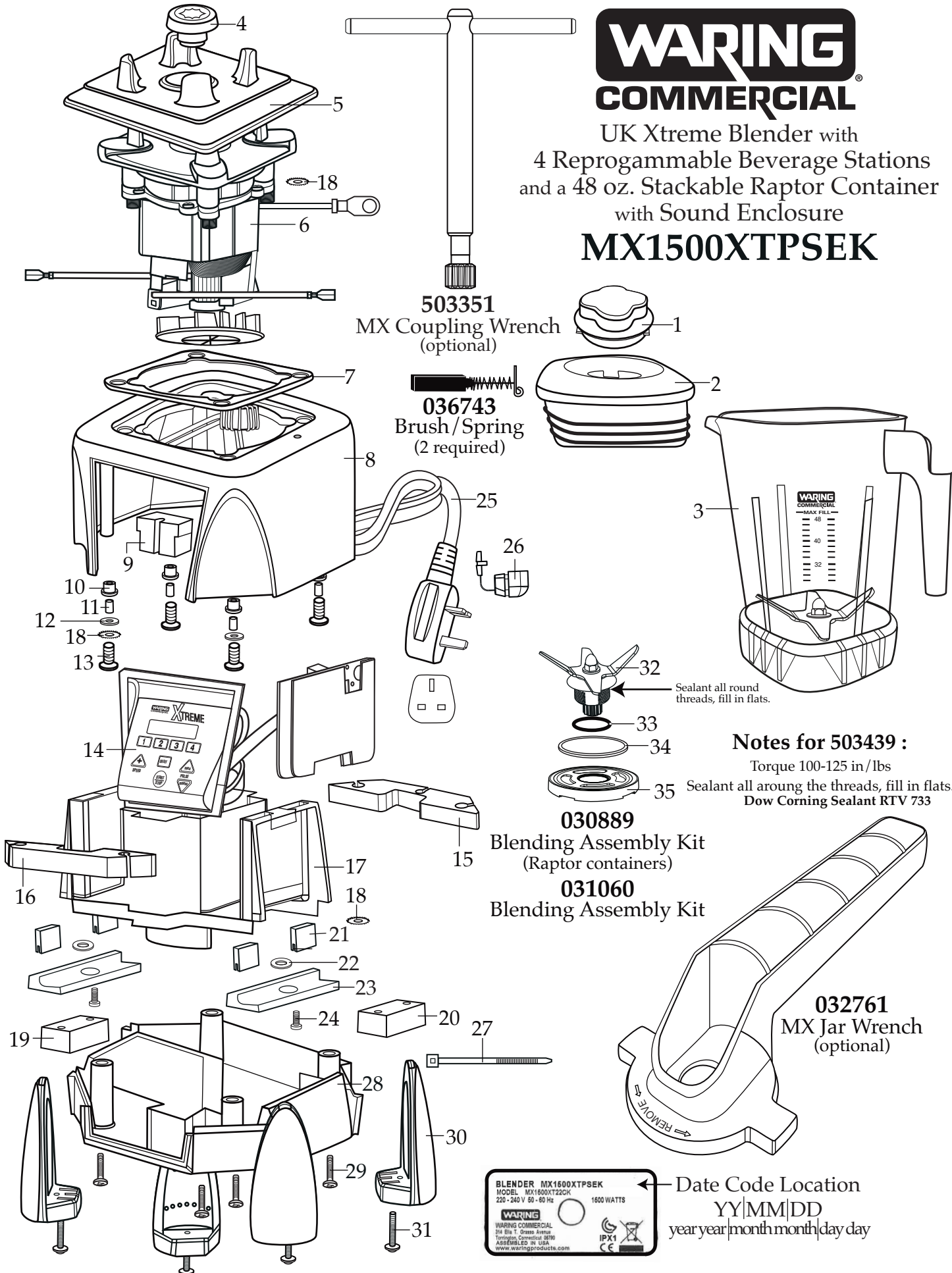

503351
MX Coupling Wrench
(optional)

036743
Brush/Spring
(2 required)

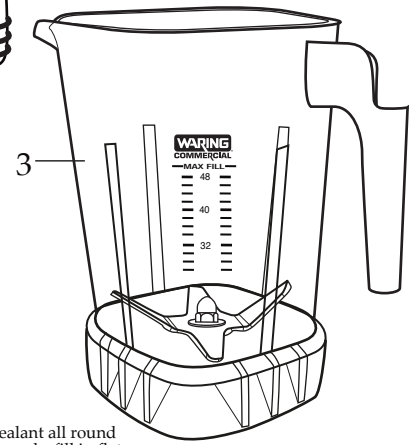

Notes for 503439 :
Torque 100-125 in/lbs
Sealant all around the threads, fill in flats.
Dow Corning Sealant RTV 733

030889
Blending Assembly Kit
(Raptor containers)

031060
Blending Assembly Kit

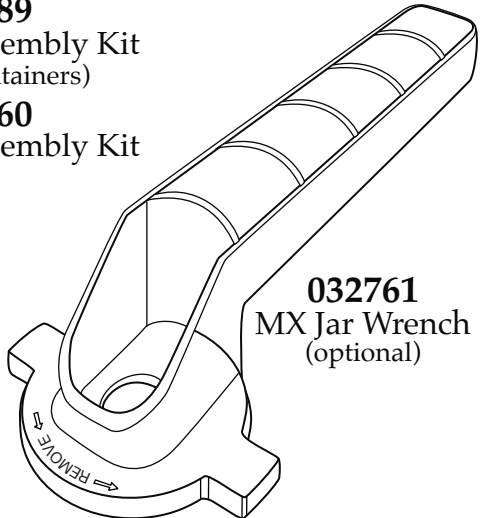

← Date Code Location
YY|MM|DD
year year|month month|day day



Illustration#	Part#	Description
1	028769-E	Jar Lid Cover <i>(changed after 10/8/2010)</i>
2	028768	Jar Lid
3	503439	48 oz Raptor Container with Blending Assembly <i>(changed after 2/28/2014)</i>
	030888	48 oz. Stackale Container ONLY
	503348	Container with Blending Assembly (use 503439)
4	503601	Sq. Drive Coupling with Adapter <i>(on units after 3/29/2022)</i>
	503604	Sq. Drive Coupling with Adapter 2 Gen. <i>(changed after 1/7/2021)</i>
	028538	Drive Coupling
5	026443	Jar Pad
6	035399	Leili Motor with Sensor <i>(on units after 8/18/2017)</i>
	028824	ECM Motor with Sensor
7	038278	Dampening Plate Gasket <i>(on units after 8/25/2022)</i>
	026437	Dampening Plate Gasket
8	503382-K-67	MX Housings, Ferrite Core & Cord <i>(on units after 10/19/2017)</i>
	503382-K	MX Housings, Ferrite Core & Cord <i>(on units after 4/27/2009)</i>
9	028541	Motor Foam (2 required)
10	026439	Dampening Plate Bushing (4 required)
11	038486	Dampening Plate Sleeve (4 required <i>on units after 8/25/2022</i>)
	026453	Dampening Plate Sleeve (4 required)
12	026459	Washer (2 required)
13	028929	Sems (4 required)
14	035710	Control Panel with Interlock <i>(changed after 8/18/2017)</i> comes with key board-main board-filter board
	029816	Soft Start Control Panel (use 035710)
15	028248	Top Housing Foam Rear Baffle
16	028249	Top Housing Foam Front Baffle
17		<i>Motor Housing is Included with Illustration# 8</i>
18	002943	Washer (3 required)
19	028247	Bottom Housing Foam Baffle
20	028542	Foam Baffle
21	034900	PCB Cushion (4 required <i>on units after 7/18/2019</i>)
22	037232	Flat Neoprene Washer (2 required <i>on units after 7/18/2019</i>)
23	037007	PCB Mounting Bracket (2 required <i>on units after 7/18/2019</i>)
24	013768	Screw (2 required <i>on units after 7/18/2019</i>)
25		<i>Cord is Included with Illustration# 8</i>
26	007556	Strain Relief <i>(on units after 10/4/2019)</i>
	012920	Strain Relief <i>(changed after 4/22/2014)</i>
	030618	Strain Relief (use 012920)
27	013731	Cable Tie (3 required <i>last used 5/31/2019</i>)
28		<i>Bottom Housing is Included with Illustration# 8</i>
29	012505	Screw (4 required)
30	026430	Corner Post (4 required)

Illustration#	Part#	Description
31	028928	Sems (4 required)
32	503397	Blade Assembly (Raptor containers)
	503345	Blade Assembly
33	024271	O Ring
34	024268	Nut Gasket
35	029631	Bearing Holder Nut

033484
Brush/Spring
(2 required use with ECM motor)

028251-E
48 oz. Eastman Outer Sound Enclosure
(changed after 8/18/2011)

026612
NSF Component

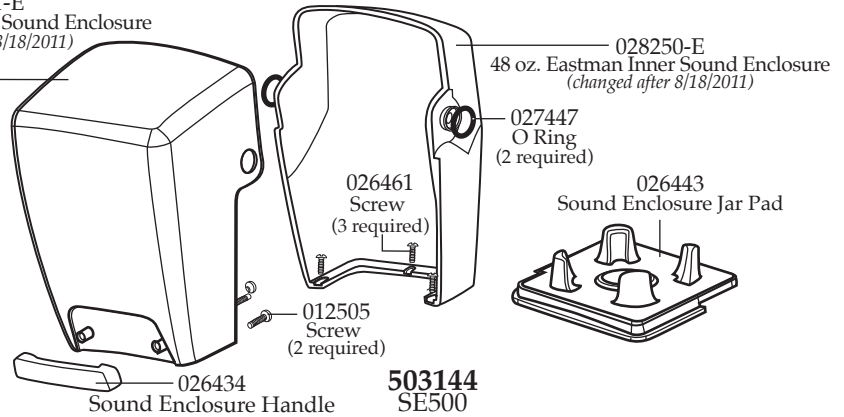

Parts No Longer Used

(Last used on 4/27/2009)

